

# CONSOLE UNIT FOR DCL-33A

## OMR-100



### Features

OMR-100 is an exclusive console unit for the DCL-33A. This makes your monitoring system compact, with up to 10 control points, yet allows significant cost-benefit control.

### Standard specifications

- Display** PV [Red 4-digit, character size: 8×4mm (H×W)]  
SV [Green 4-digit, character size: 8×4mm (H×W)]  
CH [Yellow 1-digit, character size: 8×4mm (H×W)]
- Indicator** ALM : A red LED lights when alarm output is ON.  
OUT : A green LED lights when control output is ON.  
ERR : Blinks every 2 seconds if serial communication errors occur.  
SB : A red LED lights when sensor is burnt out.  
INITIAL : A yellow LED lights when reading a setting value.  
TX/RX : A yellow LED lights during serial communication (TX).  
AT : A yellow LED lights during auto-tuning.

**Alarm output** Turns ON when alarm is activated (Common to all channels).  
Relay contact, 1a  
Control capacity, 3A 250V AC (resistive load),  
1A 250V AC (inductive load  $\cos \phi = 0.4$ )

### Serial communication

- Communication line : Based on RS-485  
Communication method : Half-duplex communication start-stop synchronous  
Communication speed : 19200bps  
Data format : Start bit 1, Data bit 7,  
Parity Even, Stop bit 1
- Transmitted contents : SV, Alarm setting value, OUT proportional cycle value,  
OUT proportional band value, Integral time value, Derivative  
time value, ARW value, Manual reset value, AT value
- Received contents : Transmitted contents above, Control input value,  
Status flag (Output status, Overscale, Underscale, During AT)
- Communication error output : Turns ON when communication errors occur.  
Relay contact, 1a  
Control capacity, 3A 250V AC (resistive load)  
1A 250V AC (inductive load  $\cos \phi = 0.4$ )

**Supply voltage** 100 to 240V AC 50/60Hz, 24V AC/DC 50/60Hz  
(For supply voltage, the standard is 100 to 240V AC. However,  
when ordering 24V AC/DC, enter "1" after model name OMR-100.)  
Allowable fluctuation range: 85 to 264V AC, 20 to 28V AC/DC  
10MΩ or greater at 500V DC

**Isolation resistance** Between power terminal and ground terminal 1.5kV AC for 1 minute  
**Dielectric strength** Between power terminal and communication terminal 1.5kV AC for 1 minute  
Between communication terminal and ground terminal 1.5kV AC for 1 minute

**Environment** Ambient temperature: 0 to 50°C,  
Ambient humidity: 35 to 85%RH (Non-condensing)

**Power consumption** Approx. 5VA

**Weight** Approx. 320g

**External dimension** 48×96×100mm(W×H×D)

**Attached functions** Self diagnosis, Warm-up indication, Error indication when changing  
setting value, Indicated value when communication errors occur

**Options** Mounting bracket [BL]: Mountable panel thickness, Within 1 to 15mm  
Dust-proof/Drip-proof [IP]: IP54  
Terminal cover [TC]: Electric shock protection terminal cover

### External dimensions

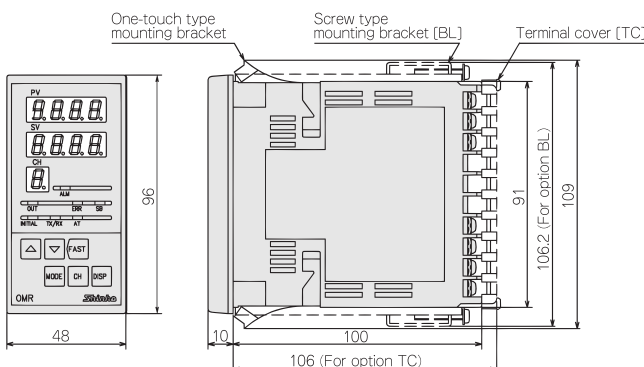

### Panel cutout

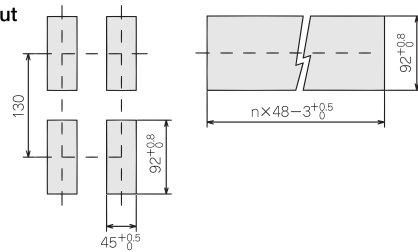

### Terminal arrangement

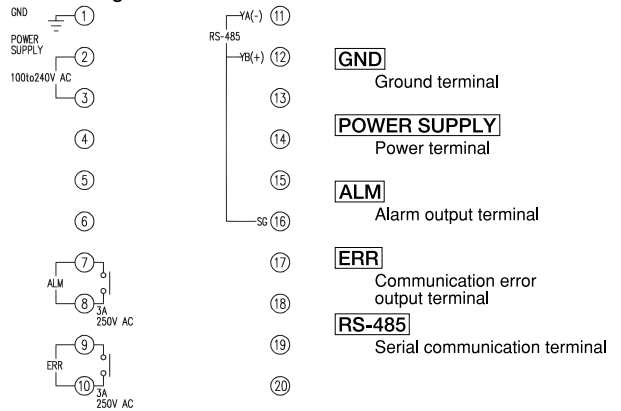

### Solderless terminal

Use a solderless terminal with isolation sleeve that fits in the M3 screw as shown below. The tightening torque should be 0.6N·m to 1.0N·m.

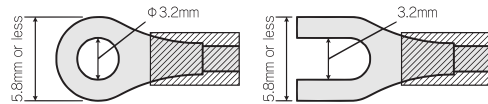

### Configuration example

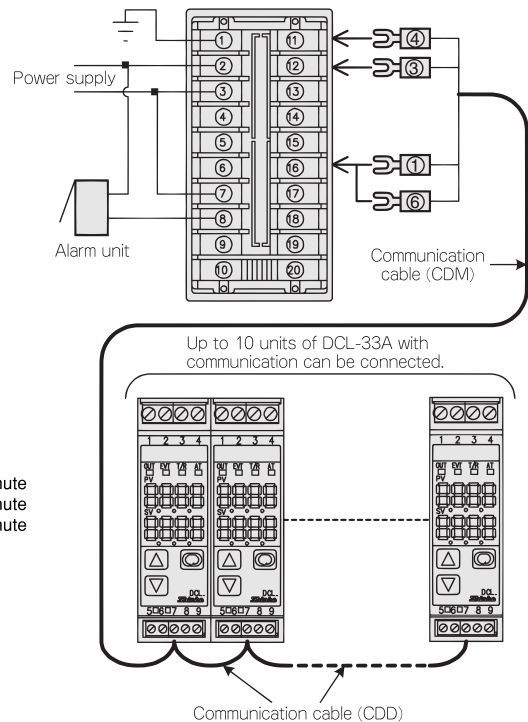

• This catalog is as of Oct. 2002, and its contents are subject to change without notice.  
• If you have any inquiries, please consult us or our agency.



## SHINKO TECHNOS CO., LTD. OVERSEAS DIVISION

Reg. Office : 1-2-48, Ina, Minoo, Osaka, 562-0015, Japan  
Mail Address: P. O. Box 17, Minoo, Osaka, Japan  
Tel : 81 - 727 - 21 - 2781  
Fax : 81 - 727 - 24 - 1760  
URL : <http://www.shinko-technos.co.jp>  
E-mail : [overseas@shinko-technos.co.jp](mailto:overseas@shinko-technos.co.jp)